

TO D.C. LINE

TO I-495

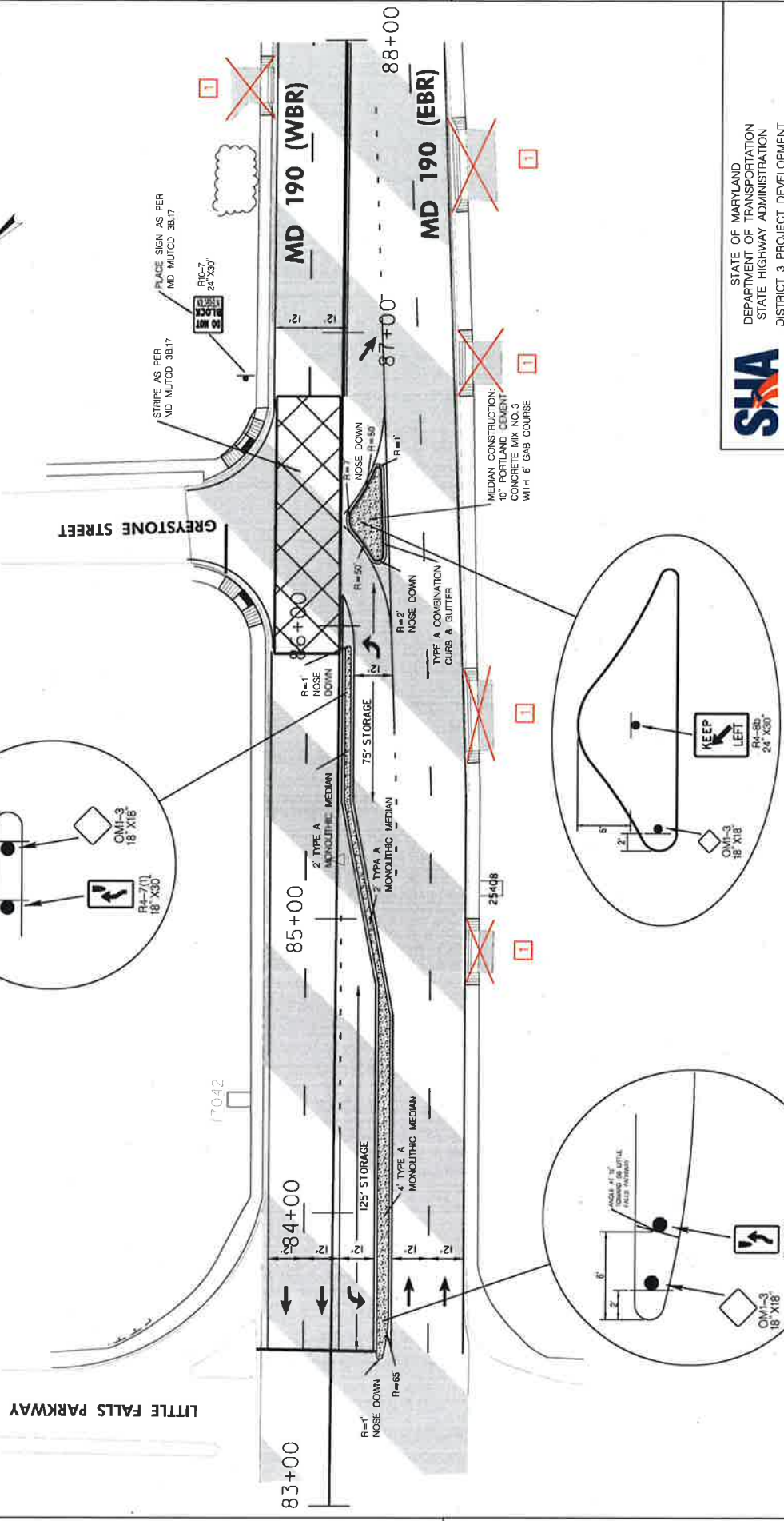

STATE OF MARYLAND
 DEPARTMENT OF TRANSPORTATION
 STATE HIGHWAY ADMINISTRATION
 DISTRICT 3 PROJECT DEVELOPMENT

MD 190 FROM MD 614 TO D.C. LINE
 SAFETY AND RESURFACING PROJECT

INTERSECTION DETAIL SHEET

SCALE 1" = 50'	ADVERTISED DATE 03-29-16	CONTRACT NO. MD0815177
DESIGNED BY JRG	COUNTY MONTGOMERY	
DRAWN BY ETH	LOGMILE 13.83 TO 15.88	
CHECKED BY TK	HORIZONTAL SCALE	
F.A.P. NO. N/A	VERTICAL SCALE	
DRAWING NO. ID-1	OF 1	SHEET NO. OF

REVISIONS

ADDENDUM #1	04/14/16
1	REDLINE 08/02/2016

ROADWAY LEGEND
 REMOVED

DRIVEWAY APRON (STD. MD 630.01)
 UNLESS OTHERWISE NOTED



PREPARED BY:
PENNONI ASSOCIATES INC.
 323 West Camden Street, Suite 600
 Baltimore, MD 21201
 T 410.878.9550
 F 410.878.9551

DRILL HOLES

DRILL HOLES

DRILL HOLES

SCALE: 1" = 50' (VERTICAL SCALE: 1" = 10')